

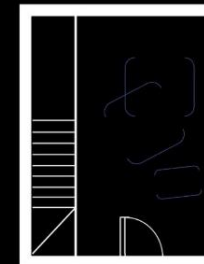

BASEMENT 63

Mchugh simultaneously deconstructs traditional art forms such as painting and sculpture, whilst questioning our relationship with the mundane, manmade objects and materials. During a period of rapid decline in an ecological, social and political sense, Mchugh uses these social fragilities to totalise the space.



Unfortunately, there is no disabled access at the gallery.

Mchugh describes herself as an artist and writer questioning society's function and formula through materiality. These physical paintings sculpturally complement the salvaged sculptures, playing with the ideas of the throw away and the discarded. Both the curator and the artist wanted the space to intertwine with the pieces, adopting this raw and temporary installation approach.



Natasha Mchugh

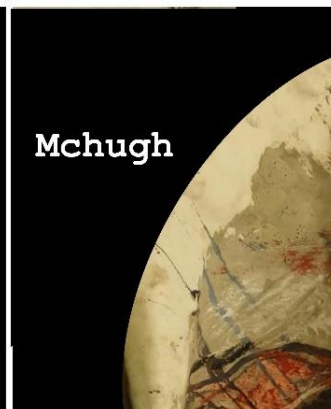

FREE ENTRY

Please turn over for more information

Curated by
Holly Bastable

FOLLOW US



www.basement63.wixsite.com/exhibitions



@basement.63



Basement_63@hotmail.com

BASEMENT

63

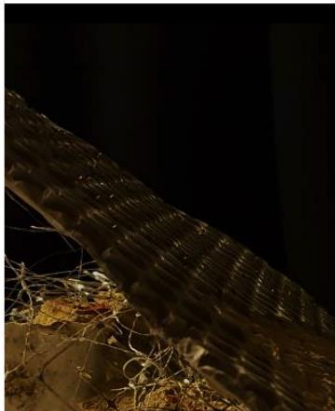

Mchugh displays these materials in their found state to question the rules of traditional sculpture and 'what is a material?'. Her physical approach to painting mimics the urban decline of our environment and the destruction caused by our wasteful, ever-expanding society.

Found materials, photography and acrylic onto canvas

DOWN
THE
HILL
WE
GO

2nd-
3rd
DEC
2019

Natasha
Mchugh

BASEMENT
63



Visiting Us:

If you would like to visit any of our exhibitions please email Basement_63@hotmail.com for visitor information and to book a free viewing appointment, or to attend one of our private views.

Alternatively, visit our website to view all the exhibition films and photographs.

How To Get Here:

Address:

63 Penrhyn Road, Kingston Upon Thames, KT1 2EQ

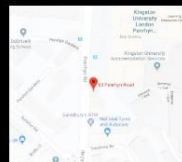

By Train

Our nearest train station is Surbiton Station which is a 15-minute walk from our main entrance. Alternatively, Kingston Station is a 20-minute walk away.

By Bus

Our nearest bus stop is Kingston University, County Hall.

By Car

We have very limited parking at the gallery, please email us to reserve a parking space.

*'...the space became the work;
the work became a space.'*

- Natasha Mchugh