

# BASEMENT 63

Stage 2 of escalating the visual importance of mundane, unassuming materials categorised as industrial packaging as they become anti-materials. The artist and curator examine the ready-mades of factory leftovers and synthesise every factor through their mechanical characteristics. Sculpture and light act as the moulding framework for these discarded forms, as the machinery moves through the media into the present space.

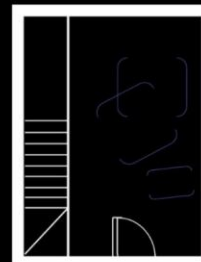

Unfortunately, there is no disabled access at the gallery.

The materials are curated as if they were in situ in the factory, mimicking the past directional travels of this dotted material through the machines. The projections depict the original factory process, playing the robotic motions of the cogs turning to retain the material origin of these salvaged plastic and cardboard objects.

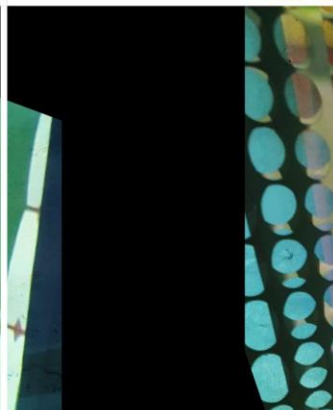

**FREE ENTRY**

Please turn over for more information

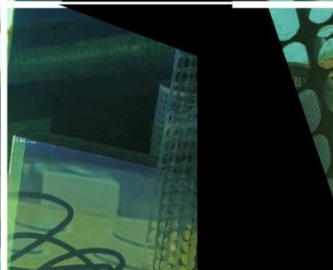

Curated by  
Holly Bastable



**FOLLOW US**



[www.basement63.wixsite.com/  
exhibitions](http://www.basement63.wixsite.com/exhibitions)



@basement.63



Basement\_63@hotmail.com



BASEMENT

63

This exhibition contains flashing lights and bright colours, if you have any concerns or queries prior to your visit to our site please email us at [Basement\\_63@hotmail.co.uk](mailto:Basement_63@hotmail.co.uk)

DOTTED

Feb 2020

BASEMENT  
63

The team practice 'Total Installation' within this pictorial space. Every colour, line, shape and form are choreographed in relation to the composition of industrial assembly-lines and storage. The light acts as an aesthetical layer to lyrically intertwine the space together. This exhibit addresses the viewer's perceptive of the unassuming and questions this by elevating its aesthetical dominance.

### Visiting Us:

If you would like to visit one of our exhibitions, please email [Basement\\_63@hotmail.com](mailto:Basement_63@hotmail.com) for visitor information and to book a free viewing appointment. We have a maximum of five slots per day, please no walk-ins. Alternatively, visit our website for all the exhibition films and photographs.

### How To Get Here:

#### Address:

63 Penrhyn Road, Kingston  
Upon Thames, KT1 2EQ

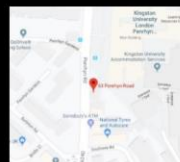

#### By Train

Our nearest train station is Surbiton Station which is 15-minute walk from our main entrance. Alternatively, Kingston Station is 20-minute walk away.

#### By Bus

Our nearest bus stop is Kingston University, County Hall.

#### By Car

We have very limited parking at the gallery, please email us to reserve a parking space.

Strip  
Deliver  
Produce  
Dispense